



HC2015 Bollard Product Specifications:

- Stainless Steel bollard with cast stainless steel cap
- Pipe is 139mm x 4mm wall thickness
- 900mm overground level and 300mm underground level
- Powder coat finish, all our products are manufactured in house so we can arrange any colour combination you require, see our colour palette section
- Fixed and Removable Versions Available

Fitting:

Fixed bollard is fixed underground level in concrete, removable bollard comes complete with retention socket

Concrete Foundations:

Fixed Bollard 500x500x300mm

Removable Bollard 500x500x300mm (hardcore for drainage is recommended under the socket before the concrete)

Options Available:

- Ram Raid Option available
- Other lengths available on request
- Matching single collar version available, see ref HC2015C with contrasting colour top
- Double collar version available, see ref HC2015DC with double collar contrasting colour top

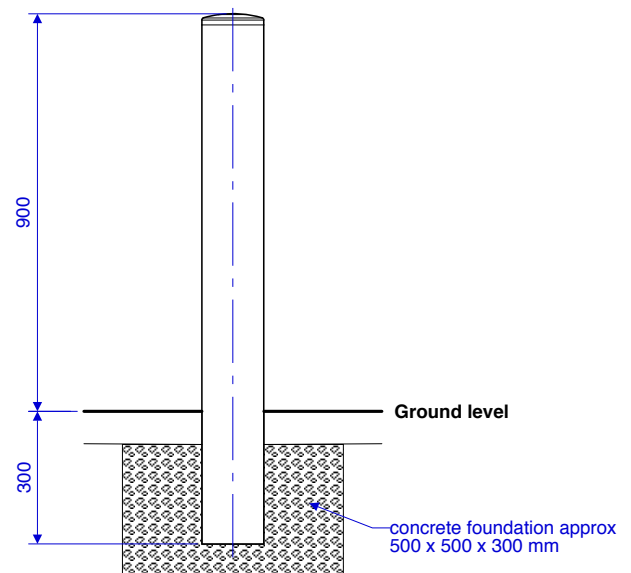
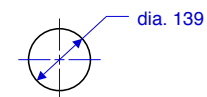

Specifications:

Pipe Dia 139mm

Wall Thickness 4mm

Overground 900mm

Underground 300mm